

MILLS AVENUE

4.5' SIDE WALK WATER & SEWER IN STR/W

N 38-1SE → 331.0

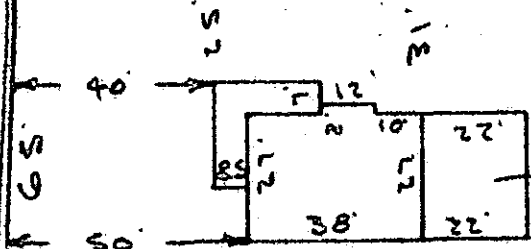

BLOCK BLDG.

-99-

343.5

← S 38-1SW

-98-

SAN. SEWER

561.50E
466.2

BRUSHY CREEK

HAWTHORNE LANE
WATER IN ST R/W
N 50-32W

GCTC --- 1 JUL 79
1471

PROPERTY OF
J. W. MOON, JR.
GREENVILLE, S.C.
SCALE: 1" = 40'
8 AUG 1979

NOTE: Improvements on this lot are not in a flood hazard area.

This is to certify that on the 8th day of August, 1979, I surveyed the property shown on this plat, being known as lot 99 on plat of LANGLEY HEIGHTS and recorded in the RMC Office Greenville County, S. C., in Plat Book " N " at Page 133; and that the property lines, walls and buildings are as shown hereon, and that the walls and buildings located on said lot do not encroach or project on adjacent street or property, and that no adjacent walls or buildings encroach or project on said premises, and no power lines cross this property except as shown hereon.

R. B. Bruce
R. B. Bruce, RLS #1952

FILED
GREENVILLE CO. S.C.
AUG 13 1 22 PM '79
DONNIE S. TANKERSLEY
R.M.C.

CAROLINA SURVEYING CO.
112 Manly St.
Greenville, S.C.

AUG 13 1979

7M-45

5221

3.00CI

216@12

105-1-1

MICROFILMED